



SIDE MOUNT DTS CONTROL

FOR MERCURY ENGINES

For use on all Mercury DTS equipped engines: Verado 150 – 400R, Mercruiser 5.0L – 8.2L, Optimax 225, Mercury Racing 565, 1100, 1350, and Cummins engines that are DTS capable



FEATURES

- **Unique lift to shift design which makes shifting smooth and effortless.**
- **Shift override and safety lanyard are built in.**
- **Available with the option of no trim switch or a single trim switch built into the knob.**
- **Made from billet anodized aluminum for saltwater use.**
- **For starboard side applications.** (Port side and center console side coming soon)
- **Available with private labeling options and a brilliant powder coat finish**
(10 colors shown on back)

DIMENSIONS

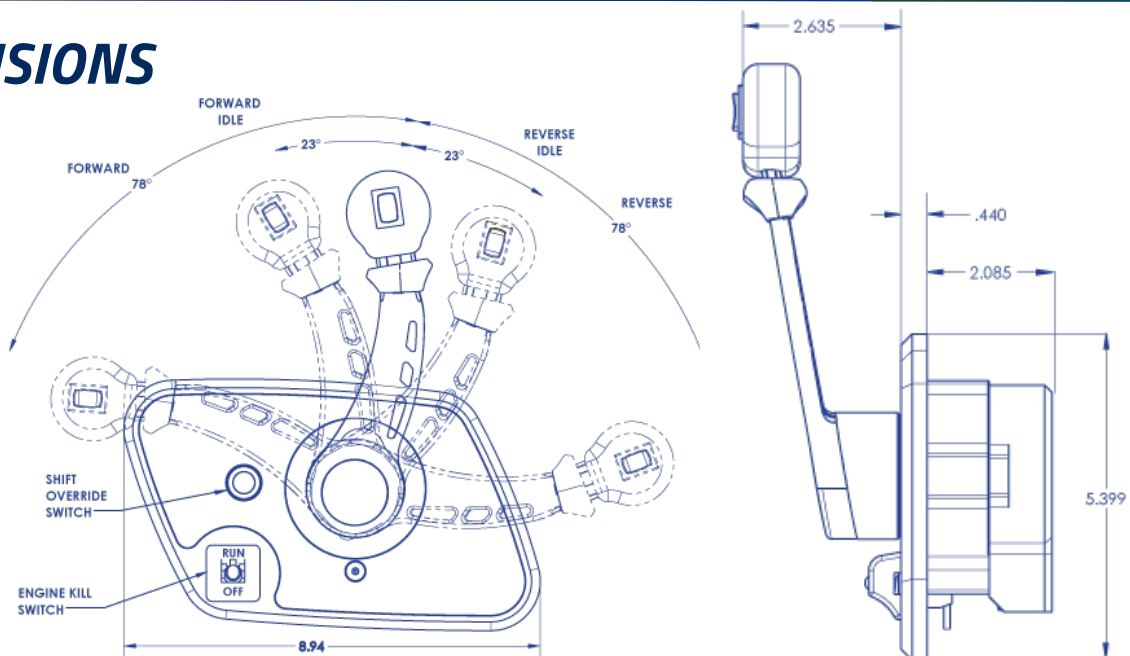

LIVORSI DTS CONTROL

STANDARD HANDLES

Livorsi Smartcraft® Digital Throttle & Shift (DTS) controls provide smooth and safe shifting. Direct drive of throttle position sensors results in faster response times, giving you complete control of your boat. These DTS controls are small and light; constructed of stainless steel and billet aluminum for years of dependable service.

- *Single, twin, triple, quad and shadow mode engine applications*
- *Ability to adjust tension for each handle*
- *Integrated single or twin drive trim switches or momentary up and down switches*



QR SERIES™ DTS BILLET CONTROL

WITH SHORTER HANDLES

Livorsi Marine's New QR Series™ throttles (Quick Response) designed for Mercury Marine's DTS compatible engines. These ergonomically designed knobs are very comfortable on the palm of your hand. The shorter levers and throw of the Livorsi QR Series™ make this control great for tight dash spaces. Electronic shifting and throttle make it easier to maneuver in tight docking spaces.

- *Knobs are available with 1, 2 or 3 switches*
- *Available in single, twin configurations and shadow mode*

Powder coat color options (for all DTS Controls)

BK black	BL blue	W white	BS silver	PU purple
L lime	MU mustard	O orange	R red	T teal

For use on all Mercury DTS equipped engines: Verado 150 – 400R, Mercruiser 5.0L – 8.2L, Optimax 225, Mercury Racing 565, 1100, 1350, and Cummins engines that are DTS capable.